

BVL-L-TERMINAL

VLD - for DC traction / Accessories for VLD

L-shaped connection bracket

L shape terminal for BVL-50-xxx or BVL-100-xxx

- terminal for BVL series
- montage on flat surfaces (steel construction, flat wires etc.)
- easy montage
- improves cooling of BVL body
- assembly material included (for BVL body + terminal assembly)
- weight 0,53 kg



Product dimensions

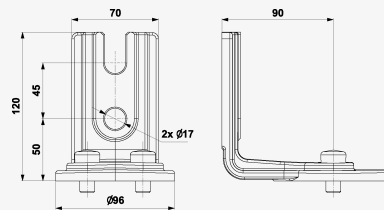

Parameter name	Parameter value
Customs tariff number	85301000
EAN	8595090566908
Order number	A06690

SALTEK s.r.o., Drážďanská 561/85, 400 07 Ústí nad Labem, CZ | +420 475 655 511 | info@saltek.cz | www.saltek.eu
Technická podpora: 800 818 818 | podpora@saltek.cz

13.04.2026 -
17:26:01